



A Community Where You Belong



Indiana Latino Expo

September 7, 2024



Celebrate Diversity

Indiana University's nine campuses offer a welcoming, inclusive environment that feels like home, whatever your background, interests, or goals. So, whether you want a Big Ten college experience, the dynamic pace of an urban research university, the community feeling of a regional campus close to home, or the flexibility of a fully online degree program, you'll find it at IU.

From nursing to criminal justice, epidemiology to environmental science, social work to cybersecurity, and more than 900 academic programs in between, IU gives you the power to study whatever sparks your interest with the support of world-class professors and faculty who care about your success.

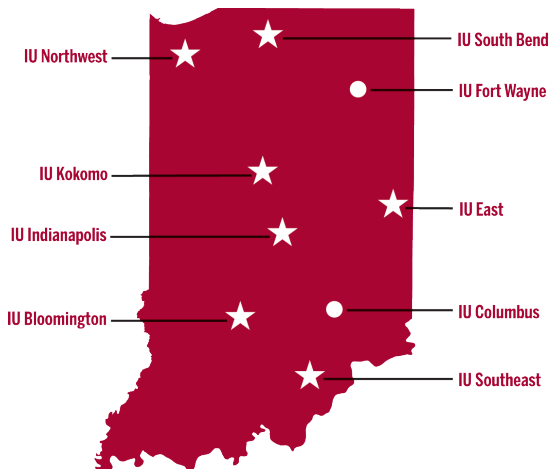



Next Stop: College

21st Century Scholars

Indiana University offers 21st Century Scholars supplementary scholarships, academic support, and other resources and tools to support students' personal and professional development.

Stop by IU's booth, learn about Indiana's 21st Century Scholars Program, and confirm and check your scholar status. High school 21st Century Scholars can complete 9th-12th grade Scholar Success Program requirements at the booth.

Speak with IU campus representatives about academics and student life. Plus, learn about the step-by-step guidance you'll receive to ensure you complete your degree on time.

21st Century Scholars

- Confirm your enrollment
- Check your scholar status
- Complete Scholar Success Program requirements





Explore All IU Campuses

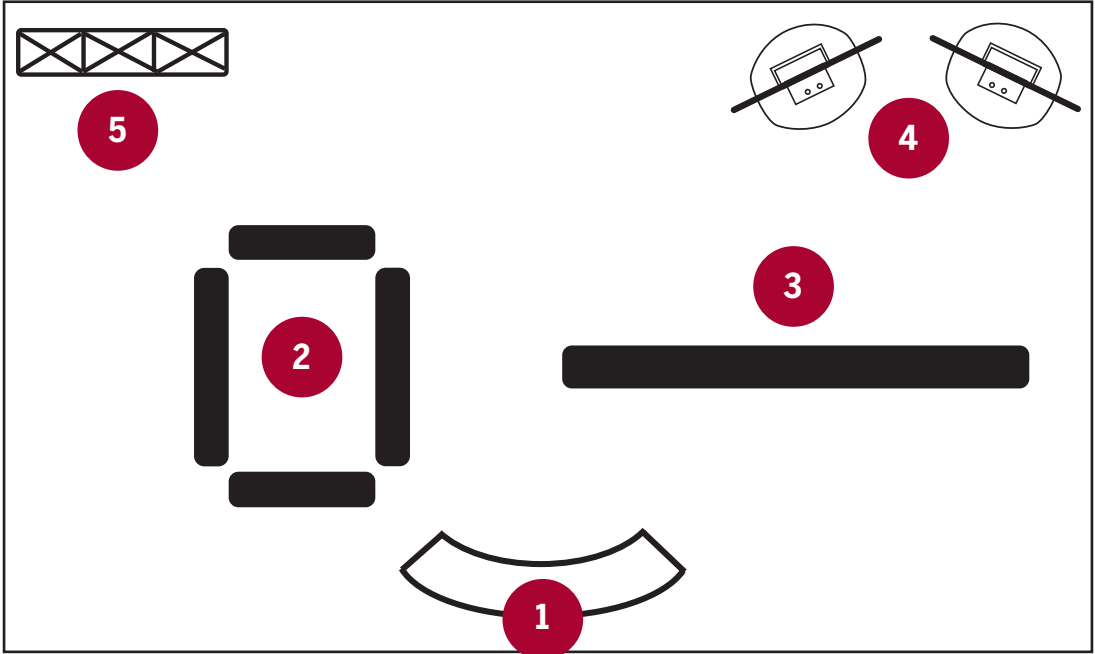

A Spanish interpreter is onsite to assist.
Please check availability at the Welcome Station.





Indiana University Booth

- 1 Welcome station (All visitors must first check in)
- 2 21st Century Scholars representatives and complete Scholar Success requirements
9th Grade “Create a Graduation Plan”
10th Grade “Take a Career Interest Assessment”
- 3 12th Grade “Submit your IU College Application”
- 4 *Open to all high school students and required for all 21st Century Scholars*

Scholar Success Videos

9th Grade “Paying for College 101”

10th Grade “Estimating College Costs”
“Get Workplace Experience”

12th Grade “College Success 101”

11th Grade Scholar Success Requirement
“Visit a College Campus” and “Search for Scholarships”

Indiana University

IU Bloomington

IU Indianapolis

IU Columbus

IU East

IU Ft. Wayne

IU Kokomo

IU Northwest

IU South Bend

IU Southeast

- 5 IU Photo Booth



You Belong at IU

Scholar Success Program

All high school students can participate in the college and career success program experiences. As part of the 21st Century Scholars' experience, a variety of program activities will take place at the IU booth. Completing these activities will fulfill several of your requirements as a 21st Century Scholar. Activities include watching videos and learning important information to help you get on the right track for college and career success!

9th Grade Scholar Success Program

“Paying for College 101”

By ninth grade, it's time to get serious about college costs and the steps you need to save and manage your money. Complete this program requirement by watching an informative video at the IU booth about calculating college costs, saving, and the various types of financial aid available.

“Create a Graduation Plan”

In 9th grade, you must create a high school Graduation Plan. It lists what courses, tests, and other steps you need to complete in high school so you have a clear path to graduation, college, and beyond. You'll update your Graduation Plan each year as your plans for after high school continue to develop. Get started by setting up an account with a scholar representative.

10th Grade Scholar Success Program

“Get Workplace Experience”

Workplace experience helps you better understand certain jobs and work environments. Watch informational interviews of IU alums from various professions, such as business, law, information technology, education, and healthcare as they share their academic and professional journey.

“Estimating College Costs”

Watch the “Estimating College Costs” video and learn how to calculate out-of-pocket costs that you and your family need to consider in preparing to pay for college.

“Take a Career Interest Assessment”

A Career Interest Assessment is a tool that asks you a series of questions to help identify careers that align with your interests and goals. The easiest way to complete this requirement is to access the Indiana Career Explorer account you created when you started your Graduation Plan as a freshman. Scholar representatives can assist you onsite.



You Belong at IU

11th Grade Scholar Success Program

“Visit an IU Campus” and “Search for Scholarships”

The 21st Century Scholarship can be applied to an eligible two-year or four-year Indiana college. You can meet program requirements at the IU booth by taking virtual tours of IU’s campuses. In addition, you’ll have an opportunity to speak directly with campus representatives to learn more about what IU has to offer.

12th Grade Scholar Success Program

“College Success 101 Video”

As a 12th grader, it’s time to prepare to transition from high school to college. Meet your program requirement by watching a 30-minute video at the IU booth on what you can do to succeed in your classes and make the most of your college experience!

“Submit Your IU College Application”

It’s also time to submit your college application! Take advantage of IU’s application waiver during the Indiana Latino Expo, where you can apply to one or more of IU’s campuses at one time. IU campus representatives will be on hand to assist you through the application process.





We Are Here to Help

Track Your 21st Century Scholar Success Progress Online

The Scholar Success Program includes various activities to keep students on track for success. Each grade level has three activities to complete. You can satisfy these requirements for your grade level and track your progress using ScholarTrack. Follow these simple steps to set up your ScholarTrack account.

Students

1. Visit **ScholarTrack.che.IN.gov** and create an account by selecting “I am a student.”
2. To create an account, you will need to share:
 - Your name
 - Your date of birth
 - Your email address
 - Your Social Security Number or your Scholar ID
3. That’s it! You are ready to start tracking your progress toward your 21st Century Scholarship online.

Parents

1. Visit **ScholarTrack.che.IN.gov** and create an account by selecting “I am a parent or guardian.” Be sure to have the following materials handy:
 - Your email address
 - Your home address
 - Your student’s Social Security Number
 - Your student’s date of birth
 - Your Individual Taxpayer Identification Number (ITIN)

It will take approximately 30 minutes to complete an application in the ScholarTrack system.

2. Once you submit an application, track your student’s progress by clicking on “View/Edit Student.”
3. That’s it! You are ready to start tracking your student’s progress toward the 21st Century Scholarship.

Questions? Email: Scholars@che.IN.gov or call 888-528-4719.



IU Application Waiver

What You Need to Know

All incoming high school seniors may take advantage of IU's application fee waiver during the Indiana Latino Expo. Use this opportunity to apply to one or more of IU's campuses for fall 2024, spring 2025, or summer 2025. IU campus representatives will be on hand to assist you in setting up your IU account and answering questions.

There are several things to keep in mind. If you're a domestic first-time freshman or transfer student, apply to IU by submitting:

- One application that you can direct to all campuses of interest to you.
- Test optional:
 - IU Bloomington and IU Indianapolis will let you decide if you want your test scores reviewed as part of your application. Please visit their admissions websites to determine if this option is right for you.
 - SAT/ACT scores can be self-reported on the application. However, official test scores are required if admitted (IU Bloomington).
- One essay (if you're applying to IU Bloomington or IU Indianapolis).
- There are academic requirements applicants must meet when applying to IU. Please speak with a campus admissions representative to learn more or visit the campus admission website to review admission standards.

The \$65 application fee is waived for Indiana Latino Expo student visitors. Once an applicant selects the primary IU campus, a representative will provide the fee waiver code.

My fee waiver code is: _____.

This code will be required for you to submit your application.



Scholarship Opportunities

Scholarships For Underserved and First-Generation Students

Any IU Campus

Visit go.iu.edu/IUScholarships to learn more.

Campus Scholarships

Jan Marie Carroll Bicentennial

Scholarship for undergraduate or graduate students on any IU campus pursuing a non-general studies degree. Students from underrepresented populations, including financially challenged students, will be given primary consideration.

Johnson Underrepresented Student

Scholarship for undergraduate or graduate student(s) on any campus who are Indiana residents from the Indianapolis Public School district.

Program Scholarships

21st Century Scholars Program provides up to four years of undergraduate tuition to income eligible students at any of IU's nine campuses, as well as step-by-step guidance and support to make sure scholars succeed in college and receive support to finish their degrees. Some campuses offer grant aid to cover indirect expenses such as room, board, and books. Visit campus websites for more information.

Groups Scholars Program provides academic, financial, and social support to help students attain a bachelor's degree at Indiana University. The program was created to increase college attendance among first-generation, high-achieving, underrepresented students. Visit campus websites to learn more.

Herbert Presidential Scholars Program

for top-achieving high school graduates in Indiana, giving them a head start on reaching their college goals with a four-year renewable scholarship to attend IU Bloomington, IU Indianapolis, or any regional campus. Funded by the Lilly Endowment Inc., the program welcomes a minimum of 30 incoming Indiana University freshmen every year. Visit HerbertScholars.iu.edu to learn more.

IU Alumni Association Scholarships

Visit go.iu.edu/IUAAScholarships to learn more.

Asian Pacific Islander Alumni Association Scholarship

for undergraduate and graduate students attending any IU campus.

Latino Alumni Association Scholarship

for undergraduate and graduate students attending any IU campus.

LGBTQ+ Alumni Association Academic Scholarship

for students on any IU campus based on their academics, career goals, financial need, leadership, community service, and extracurricular activities. Consideration is given for involvement in activities raising awareness of LGBTQ+ issues.

Neal-Marshall Alumni Club Scholarship

for undergraduate and graduate minority students attending any IU campus.

IU Bloomington

Unless otherwise indicated, visit go.iu.edu/IUScholarships to learn more.

Access to Excellence Scholarship for participants in a program within the Office of the Vice President for Diversity, Equity, and Inclusion.



Scholarships Continued

Charlie and Jeanetta Nelms

Bloomington Scholarship for incoming fall 2024 freshmen from the Indianapolis or Gary public school systems. Students majoring in education, nursing, informatics, or life sciences will be given priority. This scholarship is renewable for up to four years with the maintenance of a 2.75 GPA and a letter of reference from an academic advisor or faculty member.

The Hudson & Holland Scholars Program

Scholarship for high-achieving students from communities historically excluded due to race and ethnicity. Students selected for the program will receive a scholarship for a total amount of \$28,000 to be evenly disbursed over four years of study at Indiana University Bloomington. This means each selected student will receive a base scholarship of \$7,000 per academic year with opportunities to qualify for additional funding through HHSP campus partnerships. Visit **HudsonAndHolland.indiana.edu** to learn more.

Jeffery Haynes Hillis LGBTQ+

Scholarship for students based on leadership for LGBTQ+ issues on campus and/or in the community, a record of academic achievement, future career goals, financial need, volunteer involvement, and other extracurricular activities.

Rev. Dr. Ernest E. Butler Humanitarian

Scholarship for incoming or currently enrolled full-time students with a demonstrated commitment to religious and community involvement. Special consideration is given to underserved populations, including, but not limited to, financially challenged students and/or those with diverse cultural backgrounds.

Wilma A. and Charles E. Harry, IV Family

Scholarship for a Hudson & Holland Scholar pursuing degrees in the School of Education or the School of Social Work. Visit **go.iu.edu/IUBScholarships** for additional information.

IU Indianapolis

Visit **go.iu.edu/IUIndianapolisScholarships** to learn more.

Bowen Scholars Program for students who have maintained good standing in the Ivy Tech Bowen Scholars Program, who have been admitted to IU Indianapolis, who have earned an associate degree or are in select Ivy Tech degree programs, and who have successfully executed a transfer plan developed with the Office of IU Indianapolis/ Ivy Tech Coordinated Programs.

Nina Mason Pulliam Legacy Scholars

Program for adults with dependents in their household, college-age youth and adults with physical disabilities, or former/ current foster youth working toward a first undergraduate degree.

Norman Brown Diversity and Leadership Scholars Program

for students from populations historically underrepresented in institutions of higher education. Scholarship recipients are required to participate in the Norman Brown Scholars' protocol, which encourages academic success, leadership development, civic engagement, and diversity education. Visit **diversity.indianapolis.iu.edu/offices/mc/norman_brown/** for more information.

Senior Academy Freshman (IPS)

Scholarship for beginning freshmen to partially support tuition and books for those who show the potential for academic excellence at IU Indianapolis.



Scholarships Continued

Sindoqua Scholarship for Native Americans for members of a native tribe or once native to the state of Indiana. Priority is given to members of the Miami, Potawatomi, Shawnee, Wea, Kickapoo, Ottawa, Chippewa, Delaware, or Mahican tribes. Additional tribes recognized in the United States or Canada also may be considered.

IU East
Visit go.iu.edu/IUEScholarships to learn more.

Charlie and Jeanetta Nelms Scholarship for IU East students for demonstrated academic potential in his or her chosen field of study.

Gloria and Joseph Allwarden and Lillian and Antonio Cruz-Urbe Scholarship for IU East undergraduate or graduate students from underrepresented populations, including but not limited to financially challenged students and/or students with diverse cultural experiences.

Antonio Ochoa Memorial Scholarship for undergraduate students with financial need. Preference is given to students who are single parents. Students must be U.S. citizens or legal permanent residents.

Walter & Robert Havighurst Minority Fund for a degree-seeking student for demonstrated academic potential in his or her chosen field of study.

IU Fort Wayne
Visit go.iu.edu/IUFWScholarships to learn more.

IU Fort Wayne Academic Leadership Award for high-achieving high school seniors planning to attend IU Fort Wayne. It is a renewable, admissions-based scholarship.

IU Fort Wayne Transfer Excellence Award for all incoming students transferring to IU Fort Wayne from another college or university outside the IU system. This scholarship is admission-based and renewable for up to two years.

IU Kokomo
Visit go.iu.edu/IUKScholarships to learn more.

Cora and Franklin Breckenridge Scholarship for incoming or continuing students enrolled at IU Kokomo with either full or part-time enrollment and a minimum 2.3 GPA.

Destination: Education IUK Scholarship for Howard County residents with demonstrated financial need and who exhibit the ability to compete in university classes. Recipients may have family barriers that would prevent them from accessing college opportunities.

Gerry Gunning Stroman Scholarship for incoming freshmen enrolled full-time with financial need. A minimum high school GPA of 2.3 is required. Special consideration is given to underrepresented populations, including but not limited to financially challenged students and/or students with diverse cultural experiences. Renewable provided recipients continue to meet the criteria.

Kokomo Diversity Scholarship for those who want to contribute to diversity at IU Kokomo. The scholarship recognizes new students committed to bringing diversity to IU Kokomo, whether through lived experience, thought, word, or action. The scholarship is \$1500 and is renewable for three additional years. Students must be admitted and submit a scholarship application to IU Kokomo by March 1.



Scholarships Continued

IU Northwest

Visit go.iu.edu/IUNScholarships to learn more.

Chase Scholarship for African American or Latino students with demonstrated financial need who reside in Lake or Porter County in Indiana. To compete for this award, students should rank in the top 25% of their graduating class and demonstrate leadership ability.

Dual Credit Scholarship for new students who earn at least 6 college credits through Indiana University while in high school will receive a \$500 renewable award with a 2.8 GPA.

ILI Promise Scholarship for high school students enrolled in ILI's College Prep program for one full year. Eligibility changes are based on each of the 23 participating universities' requirements and guidelines. Scholars must maintain enrollment in ILI's College Coaching through college to keep their scholarship, which provides full tuition for four years.

IU Northwest Pledge Grant for new full-time students with a minimum of 2.3 cumulative high school GPA and a 21st Century Scholarship, Pell Grant, or Frank O'Bannon Grant. The grant ranges from \$100 to \$2,000 annually based on financial need for those students who file the FAFSA by April 15 and enroll in courses by June 1.

Latino Hoosier Hero Scholarship for full-time students with a cumulative GPA of 3.0 or higher. Preference is given to students of Latino heritage for this annual scholarship. The scholarship may be renewed with a cumulative GPA of 3.0 or above.

Student Support Services Scholarship

for low-income qualifying students who are both first in their families to attend college and who have disabilities.

IU South Bend

Visit go.iu.edu/IUSBScholarships to learn more.

Dr. Richmond E. Calvin Scholarship

awarded to African American/Black sophomores, juniors, or seniors pursuing a degree and career in education; the scholarship is renewable provided students maintain a 2.0 GPA.

IU South Bend Black Council

Scholarship supports financial awards for meritorious students; preference is given to African American students attending IUSB.

Opportunity Scholarship special consideration will be given to underrepresented populations, including but not limited to financially challenged students and/or students with diverse cultural experiences.

"Your Dreams are Possible" Karen White Scholarship

for sophomores enrolled full-time at IU South Bend who are 21st Century Scholars, have financial need, a minimum GPA of 2.5 on a 4.0 scale, no academic or disciplinary probation actions, and engaged in community service while attending high school.



Scholarships Continued

IU Southeast

Visit go.iu.edu/IUScholarships to learn more.

Black Achievers Scholarship for incoming students with a SAT of 1000 or ACT of 20, minimum high school GPA of 2.5; Gain regular admission to IU Southeast; Must be a Louisville Black Achiever Program participant. Scholarship may be renewed if the cumulative IU GPA is 2.5 or above.

J. Terrence and Peggy Cody

Scholarship for African American and/or first [1st] generation students interested in majoring in business and economics. Nursing students will also be considered as recipients. Must be a resident of Indiana. Requires full time enrollment each semester and may be renewed with 2.5 or higher cumulative IU GPA.

Monroe Shine Scholarship for business students majoring in accounting with intent on entering public accounting upon graduation. Preference given to minority students. Award covers books, fees, and tuition for up to 15 hours.





Precollege Programs

Experience for Life

IU offers a wide range of programs year-round for students of all ages and interests, from pre-K through high school. Whatever your goals, we have a precollege program for you! For a complete list, view our campus websites.

Advance College Project

High School, Indiana University,
acp.iu.edu/about/

Advance College Project (ACP) is a dual enrollment partnership between Indiana University and select high schools throughout Indiana and surrounding states. IU courses offered through ACP are taught by specially trained high school teachers who meet the professional and academic expectations of the on-campus department and the Higher Learning Commission. ACP helps empower students to begin higher education plans before leaving the high school classroom, providing the critical thinking and work ethic needed to succeed at the next level.

African American Arts Institute Camp S.O.U.L.

High School, IU Bloomington, 812-855-3676,
go.iu.edu/aaai-campsoul

Spend six days performing and learning about African American musical art forms, including spirituals, blues, gospel, R&B, soul, and hip-hop.

Career Pathways

High School, IU Kokomo, 765-455-9570

College to Career Pathways is for high school students who want to start their bachelor's degree early and become tomorrow's...teachers, healthcare professionals, business professionals, computer scientists, and more. Pathway programs include dual credit coursework, career exploration, college advising, and hands-on learning!

IU Student Success Corps Program

K-12, IU Indianapolis, 317-278-2000,

engage.indianapolis.iu.edu/partner/student-achievement/tutoring-mentoring

The IU Student Success Corps Program provides tutoring, mentoring, family engagement, and college and career readiness support to K-12 students. The evening program virtually serves 6th -12th grade students across the state. For more information or to enroll, call the IUI Office of Community Engagement at (317) 278-2000 or visit the website.

Jim Holland Summer Enrichment Program

Grades 8, 9 & 10, IU Bloomington,
812-856-3984

Broaden your horizons in science with dynamic lectures, discussions, and laboratory experiences.

Luddy Summer Technology Camps

High School, IU Indianapolis,

luddy.indianapolis.iu.edu/admissions/precollege/summer-camp/

Various one-week camps provide learning opportunities that improve students' computer skills. Faculty from the Luddy School of Informatics, Computing, and Engineering in Indianapolis teach the sessions and help students explore in-demand career options.

The **College Readiness Academy** is designed to help you understand the resources available for college readiness planning. Grouped by grade level, it provides information sessions and hands-on workshops to help navigate the college-going process at critical, time-sensitive points along your journey. Visit **CollegeReady.indiana.edu** to learn more.

IU Bloomington
Office of Admissions
940 E. Seventh Street
Bloomington, IN 47405
812-855-0661
admissions.indiana.edu

**Office of Diversity,
Equity, and Inclusion**
Bryan Hall 115
107 S. Indiana Avenue
Bloomington, IN 47405
812-856-5700
diversity.iu.edu

21st Century Scholars
300 N. Eagleson Avenue
Bloomington, IN 47405
812-856-1910
21CenturyScholars.indiana.
edu

IU Indianapolis
Office of Admissions
Campus Center 255
420 University Boulevard
Indianapolis, IN 46202
317-274-4591
indianapolis.iu.edu/
admissions

**Division of Diversity,
Equity, and Inclusion**
University Hall 4054
301 University Boulevard
Indianapolis, IN 46202
317-278-3820
diversity.indianapolis.iu.edu

21st Century Scholars
Taylor Hall B10
815 W. Michigan Street
Indianapolis, IN 46202
317-274-5973
21stCentury.indianapolis.
iu.edu

IU Columbus
Office of Admissions
4601 Central Avenue
Columbus, IN 47203
812-348-7390
columbus.iu.edu/
admissions

**Diversity, Equity, and
Inclusion**
Campus Center 249
4601 Central Avenue
Columbus, IN 47203
812-348-7251
iupuc.edu/campus-life/
diversity-council

21st Century Scholars
Campus Center 156H
4601 Central Avenue
Columbus, IN 47203
812-348-7356
iupuc.edu/university-
college/21st-century

IU East
Office of Admissions
Whitewater Hall 151
2325 Chester Boulevard
Richmond, IN 47374
765-973-8208
east.iu.edu/admissions

**Office of Diversity,
Equity, and Inclusion**
Springwood Hall 204
2325 Chester Boulevard
Richmond, IN 47374
765-973-8474
east.iu.edu/diversity

21st Century Scholars
Office of Student Success
Whitewater Hall 116
2325 Chester Boulevard
Richmond, IN 47374
765-973-8235
east.iu.edu/oss

IU Fort Wayne
Office of Admissions
Neff Hall 110
2101 E. Coliseum Boulevard
Fort Wayne, IN 46805
260-257-6760
FortWayne.iu.edu/
admissions

**Office of Diversity,
Equity, and Inclusion**
Kettler Hall, Room 161
2101 E. Coliseum Boulevard
Fort Wayne, IN 46805
260-481-0290
ftw.edu/offices/dei

21st Century Scholars
Walb Student Union 120
2101 E. Coliseum Boulevard
Fort Wayne, IN 46805
260-481-6438
FortWayne.iu.edu/paying-
for-college/21-century-
scholars

IU Kokomo
Office of Admissions
Kelley Student Center 230
2300 S. Washington Street
Kokomo, IN 46904
765-455-9217
kokomo.iu.edu/admissions

**Office of Student Life
and Campus Diversity**
Kelley Student Center 201D
2300 S. Washington Street
Kokomo, IN 46904
765-455-9203
kokomo.iu.edu/diversity

21st Century Scholars
Office of Admissions
Kelley Student Center 230
2300 S. Washington Street
Kokomo, IN 46904
765-455-9217
kokomo.iu.edu/financial-
aid/iuk-scholarships.html

IU Northwest
Office of Admissions
Hawthorn Hall 100
3400 Broadway
Gary, IN 46408
219-980-6991
northwest.iu.edu/
admissions

**Office of Diversity,
Equity, and
Multicultural Affairs**
Hawthorn Hall 234
3400 Broadway
Gary, IN 46408
219-980-6596
northwest.iu.edu/diversity

21st Century Scholars
Hawthorn Hall 101D
3400 Broadway
Gary, IN 46408
219-980-6884
northwest.iu.edu/
academic-success/21st-
century-scholars

IU South Bend
Office of Admissions
Administration Building 140
1700 Mishawaka Avenue
South Bend, IN 46615
574-520-4839
admissions.iusbu.edu

**Office of Institutional
Equity and Inclusive
Excellence**
Administration Building 234
1700 Mishawaka Avenue
South Bend, IN 46615
574-520-5536
SouthBend.iu.edu/
affirmative-action

21st Century Scholars
Titan Success Center
Administration Building 146
1700 Mishawaka Avenue
South Bend, IN 46615
574-520-5050
academics.iusbu.edu/titan-
success-center/21st-
century

IU Southeast
Office of Admissions
University Center South 102
4201 Grant Line Road
New Albany, IN 47150
812-941-2212
southeast.iu.edu/
admissions

**Office of Equity and
Diversity**
University Center South 231
4201 Grant Line Road
New Albany, IN 47150
812-941-2599
southeast.iu.edu/diversity

21st Century Scholars
University Center South 010
4201 Grant Line Road
New Albany, IN 47150
812-941-2675
southeast.iu.edu/21st-
century-scholars

**University-Wide
Precollege Programming
Community & School
Partnerships**
812-856-5935
cpartner@indiana.edu
CollegeReady.indiana.edu

